

**AIR CRUISE PROGRAM
FOR SUMMER TRAINING
1972**

PREVIEW

You will be visiting three operational Air Force bases during your phase of the Air Cruise Program: Mather AFB, Beale AFB, and Luke AFB or Bergstrom AFB. Additionally, you will spend a day at the U. S. Army Field Artillery Center, Fort Sill, commanded by Major General Roderick Wetherill.

Mather AFB is the home of navigator training in the USAF. Colonel Charles G. Cleveland commands the 3535 Nav Tng Wg which administers this training. Here you will see how the fledgling navigator becomes an integral part of the flying crew.

Beale AFB is a part of the Strategic Air Command. You will be hosted by the 9 Strat Recon Wg commanded by Colonel Harold Confer and be briefed on the SR-71.

At Bergstrom AFB or Luke AFB Tactical Air Command will host you. The 58 Tac Ftr Wg at Luke AFB or the 67 Tac Recon Wg at Bergstrom AFB will give each of you a ride in an F-4. In addition, you will receive ground training and get a chance to observe how a fighter squadron functions. The 58th is commanded by Colonel John Clark and the 67th is commanded by Colonel Walter F. Daniel.

At all bases you will get a chance to see how an aircrew member is trained. This is the primary mission of Air Cruise. Take advantage of this opportunity to find out about the "Real Air Force."

TABLE OF CONTENTS

	<u>Page</u>
Preview	1
Table of Contents	2
Schedule of Events, USAFA	3
Schedule of Events, Fort Sill	6
Schedule of Events, Mather AFB & Beale AFB	7
Mather AFB Facilities	11
Map Mather AFB	15
Schedule of Events, Luke AFB	17
Luke AFB Facilities	21
Map Luke AFB	23
Cadet Information	25
Emergency Procedures	27

SCHEDULE OF EVENTS

USAF ACADEMY

Monday, 12 June

0730	Breakfast	MH
0800	Introduction	L6
0945	Introduction	Planetarium
1045	Equipment Issue	VH 1C4
1200	Lunch	MH
1300	Lessons 1/2	4D35 (A Flight)
		4D37 (B Flight)
		4D39 (C Flight)
		4D41 (D Flight)
		4D43 (E Flight)
1830	Dinner	MH

Tuesday, 13 June

0730	Breakfast	MH
0800	Lessons 3/4	4D35 (A Flight)
		4D37 (B Flight)
		4D39 (C Flight)
		4D41 (D Flight)
		4D43 (E Flight)

Tuesday, 13 June (Cont'd)

1200	Lunch	MH
1300	Lesson 5	4D35 (A Flight)
		4D37 (B Flight)
		4D39 (C Flight)
		4D41 (D Flight)
		4D43 (E Flight)
1830	Dinner	MH

Wednesday, 14 June

0600	Breakfast	MH (A, B, & Element 1 C Flight)
0630	Meet Bus--Fly Local	MH (A, B, & Element 1 C Flight)
0730	Breakfast	MH (Element 2 C Flight, D& E Flight)
1100	Lunch	MH (Element 2 C Flight, D& E Flight)
1130	Meet Bus--Fly Local	MH (Element 2 C Flight, D& E Flight)
1200	Lunch	MH (A, B, & Element 1 C Flight)
1830	Dinner	MH

Thursday, 15 June

0730	Breakfast	MH
0800	Lesson 6/7	L2 (A, B, & Element 1 C Flight)
		L6 (Element 2 C Flight, D& E Flight)
1200	Lunch	MH

Thursday, 15 June (Cont'd)

1300	Lesson 8	4D35 (A Flight) 4D37 (B Flight) 4D39 (C Flight) 4D41 (D Flight) 4D43 (E Flight)
1830	Dinner	MH

Friday, 16 June

0600	Breakfast	MH
0630	Meet Bus-- Fly to Ft Sill OK	South Ramp, New Dorm

SCHEDULE OF EVENTS

FORT SILL, OKLAHOMA

Friday, 16 June

1100	Arrive Henry Post AAF	
1130	Lunch	Bldg 5676, 5678, and 5684
1330	Bus to Firepower Show	
1605	Bus to BOQ	
1635	Dinner	Bldg 5676, 5678, and 5684
1845	Assemble for Cadet Hop	Bldg 5676 and 5678
2000	CG's Reception and Cadet Hop	O' Club

Saturday, 17 June

0600	Breakfast	Bldg 5676, 5678, and 5684
0730	Bus to Aircraft	Bldg 5676 and 5678
0800	Depart for Mather AFB	

SCHEDULE OF EVENTS

MATHER AFB AND BEALE AFB

Saturday, 17 June

1400	Land Mather AFB	
1500	Informal Gathering	O'Club
1700	Dinner	Dining Hall #2, Bldg 339

Sunday, 18 June

0800	Bus to Breakfast	Dining Hall #2, Bldg 339
0900	Briefing and Tour	Bldg 2860, Rm A
1100	Off Duty	
1200	Bus to Lunch	Dining Hall #2, Bldg 339
1700	Bus to Dinner	Dining Hall #2, Bldg 339

The ground training for the cadets will vary depending upon the type mission each individual will fly. UNT ground training will be in Bldg 2785. NBT ground training will be in Bldg 3875. EWO training will be in Bldg 2900. The briefing for flying will be in Bldg 4750. The show time for flying will vary from 0300 to 1200 hours.

Monday, 19 June

0700	Breakfast	F. R. Mess, Bldg 1705
0800	EWO Ground Training	Bldg 2900 (A & B Flights)
	UNT Ground Training	Bldg 2785 (C Flight)
	NBT Ground Training	Bldg 3875 (D Flight)
1200	Lunch	F. R. Mess, Bldg 1705
1300	EWO Ground Training	Bldg 2900 (A & B Flights)
	NBT Ground Training	Bldg 3875 (C Flight)
	UNT Ground Training	Bldg 2785 (D Flight)
1730	Dinner	F. R. Mess, Bldg 1705

8

Tuesday, 20 June

0700	Breakfast	F. R. Mess, Bldg 1705
As Scheduled	Fly	Bldg 4750 (C & D Flights)
0800	UNT Ground Training	Bldg 2785 (A Flight)
	NBT Ground Training	Bldg 3875 (B Flight)
1200	Lunch	F. R. Mess, Bldg 1705
1300	NBT Ground Training	Bldg 3875 (A Flight)
	UNT Ground Training	Bldg 2785 (B Flight)
1730	Dinner	F. R. Mess, Bldg 1705

Wednesday, 21 June

0700	Breakfast	F. R. Mess, Bldg 1705
As Scheduled	Fly	Bldg 4750 (A & B Flights)
0800	EWO Ground Training	Bldg 2900 (C & D Flights)
1200	Lunch	F. R. Mess, Bldg 1705
1300	EWO Ground Training	Bldg 2900 (C & D Flights)
1730	Dinner	F. R. Mess, Bldg 1705

Thursday, 22 June

0700	Breakfast	F. R. Mess, Bldg 1705
As Scheduled	Fly	Bldg 4750 (C & D Flights)
0830	Bus to Beale	Bldg 2750 (A & B Flights)
1000	Arrive Beale	
1015	Welcome to Beale AFB and Briefing	Bldg 1086
1230	Lunch	Burch Inn
1315	PSD	
1400	Static Display	
1500	Question Period	Bldg 1086
1530	Depart Beale	
1730	Dinner	F. R. Mess, Bldg 1705

Friday, 23 June

0700	Breakfast	F. R. Mess, Bldg 1705
As Scheduled	Fly	Bldg 4750 (A & B Flight)
0830	Bus to Beale AFB	
1015	Welcome to Beale AFB and Briefing	Bldg 1086
1230	Lunch	Burch Inn
1315	PSD	
1400	Static Display	
1500	Question Period	Bldg 1086
1530	Depart Beale	
1730	Dinner	F. R. Mess, Bldg 1705

Saturday, 24 June

0630	Check Out and Baggage Loading	
0730	Bus to Breakfast	Dining Hall #2, Bldg 339
0930	Fly T-29--Mather AFB to Luke AFB or Bergstrom AFB	

MATHER AFB

Barber Shops

Officers Club	Ext 3400
Mon-Fri	0900-1800
Sat	0900-1600
BX	Ext 3861
Mon, Tues, Thurs, Fri	0800-1800
Wed	0800-2000
Sat	0800-1500

Bowling Lanes

Bldg 2480	Ext 2776
Mon-Fri	0900-2330
Sat	0800-2330
Sun & Holidays	1100-2330

Bus Service

Shuttle busses operate between all major work areas on the main base. Current schedules are posted on bulletin boards.

Military bus service is provided between Mather AFB and the USO in Sacramento. Busses depart Denker Hall Service Club: Mon - Thurs: 1900 and 2145; Fri: 2400; Sat: 1400, 1800, 2000, 2245, and 2400; and Sun: 1400, 1800, and 2145. All busses depart USO a half-hour after the Mather departure.

Chapel #1 (Base)

Protestant	Ext 4375
Sunday Worship	0930
Catholic	Ext 4375
Sunday Mass	0800, 1100, 1900
Daily Mass	1200
Confessions	1730-1800

Jewish Congregation B'Nai Israel 3600 Riverside Blvd	446-4861
Mosaic Law Congregation 1114 23rd Street	444-6344
Dining Hall	
Airmens (Bldg 1226)	Ext 2572
Mon- Fri	
Breakfast	0530-0815
Lunch	1030-1300
Supper	1530-1800
Sat-Sun	
Breakfast	0600-0930
Lunch	1100-1300
Dinner	1530-1800
Field Ration Mess Mon- Fri Only	0630-0800 1100-1315 1630-1815
Golf Course	
Bldg 8855	Ext 3134
Tues-Sun	0630-Dark
Mon	Closed
Post Office	
Bldg 2566	Ext 4118
Mon- Fri	0830-1630
Sat	0830-1230
Special Services Supply	
Bldg 3452	Ext 2623
Mon-Thurs- Fri	1000-1730
Tues-Wed	1000-1645
Sun	1100-1700
Sat-Holidays	Closed

Swimming Pool	
Officers Pool	Ext 2462
Wed-Sun	1200-1900
Mon-Tues	Closed
Theater	
Bldg 1425	Ext 3829
Daily	1815, 2015
Matinee	
Sat-Sun	1300
3538 Nav Tng Sqdn	
Bldg 4445	Ext 4261
3539 Nav Tng Sqdn	
Bldg 4445	Ext 2228
3540 Nav Tng Sqdn	
Bldg 2860	Ext 2843

DRESS REQUIREMENTS FOR OFFICERS OPEN MESS,
MATHER AFB

Military Uniform: Service uniform with coat may be worn all year throughout the Open Mess during all hours of operation. The summer uniform without tie may be worn all year throughout the Open Mess during all hours of operation, Sunday through Friday, and until 1900 hours on Saturdays.

Flying Clothing: Flying suits are prohibited in the Open Mess or on the patio after 1900 hours.

Stag Bar: Any appropriate attire may be worn during hours of operation.

Civilian Dress: Gentlemen - Informal dress, shirt and slacks, may be worn throughout the Open Mess Sunday through Saturday until 1900 hours on Saturday when a coat with turtle neck shirt or coat with shirt and tie will be required. Standard Bermuda shorts may be worn in the Open Mess, March through October, until 1900 hours.

Ladies - Any attire, in good taste, with the exception of shorts or blue jeans, may be worn in the Open Mess until 1900 hours. After 1900 hours only styled pant suits or dresses may be worn, in addition to commonly accepted cocktail or dinner attire. Hotpants may be worn any evening except Saturday night. It is pointed out that if, in the opinion of the management (Club Officer or his designated steward), your attire is not in good taste, you may be asked to leave the Open Mess.

Inappropriate Attire: Blue jeans, Jamaica shorts, cut off or unhemmed Bermuda shorts, T-shirts, sweat shirts, bathing suits, or similar attire is not permitted inside the Open Mess at any time. Shoes with socks must be worn at all times.

AN INDIVIDUAL ENTERING AN OFFICERS CLUB
COVERED WILL BE ASKED TO BUY A ROUND
FOR THE HOUSE!!!

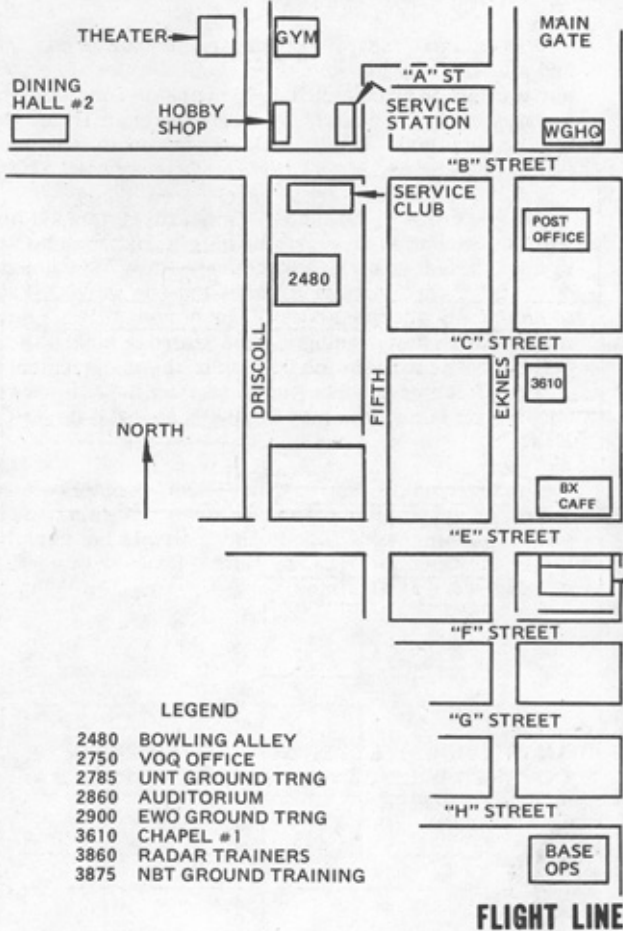

HOSPITAL &
DENTAL CLINIC

OFFICERS'
FIELD RATION
MESS

VOQ

2900

BANK

TENNIS
POOL

2750

2860

CREDIT
UNION

"O" CLUB

2785

BASE
EXCHANGE

SEVENTH

GILBERT

3860

TO BASE HOUSING

SIXTH

AIRMANS'
POOL

FRANCIS

3875

FAMILY
SERVICES

MISSION
BRIEFING

MATHER AFB

SCHEDULE OF EVENTS

LUKE AFB

Saturday, 24 June

1230	Land Luke AFB	
1245	Bus to VOQ	
1730	Dinner	Dining Hall #1, Bldg 543

Sunday, 25 June

17

0700	Breakfast	Dining Hall #1, Bldg 543
0800	F-4 Egress Training	426 TFTS, Bldg 473
1200	Lunch	Dining Hall #1, Bldg 543
1300	Welcome Party	O'Club Pool
1730	Dinner	Dining Hall #1, Bldg 543

Monday, 26 June

0630	Breakfast	Dining Hall #1, Bldg 543
0730	Squadron Operations and Flight Briefings	426 TFTS, Bldg 473 (A Flight) 311 TFTS, Bldg 445 (B Flight) 550 TFTS, Bldg 904B (C Flight)
1130	Lunch	Dining Hall #1, Bldg 543

Monday, 26 June (Cont'd)

1300-1600	Simulator Flight Facilities Phoenix Approach Control	Bldg 616 (A Flight) Bldg 473 (B Flight) Meet bus at O'Club (C Flight)
1730	Dinner	Dining Hall #1, Bldg 543

Tuesday, 27 June

0700	Breakfast	Dining Hall #1, Bldg 543
0800-1500	Gunnery Range	Meet bus at O'Club (A Flight)
0800-1100	Simulator Flight Facilities	Bldg 616 (B Flight) Bldg 473 (C Flight)
1100	Lunch	Dining Hall #1, Bldg 543 (B & C Flight)
1300-1500	Squadron Operations and Flight Briefings	Bldg 445 (B Flight)
1300-1600	Simulator	Bldg 616 (C Flight)
1730	Dinner	Dining Hall #1, Bldg 543

Wednesday, 28 June

0700	Breakfast	Dining Hall #1, Bldg 543
0800-1200	Phoenix Approach Control	Meet bus at O'Club (A Flight)
0800-1500	Gunnery Range	Meet bus at O'Club (B Flight)

Wednesday, 28 June (Cont'd)

0800-1100	Simulator	Bldg 616 (C Flight)
1100	Lunch	Dining Hall #1, Bldg 543 (C Flight)
1200	Lunch	Dining Hall #1, Bldg 543 (A Flight)
1300-1500	26 NORAD	Meet bus at O'Club (C Flight)
1400-1600	Squadron Operations and Flight Briefings	426 TFTS, Bldg 473 (A Flight)
1730	Dinner	Dining Hall #1, Bldg 543

Thursday, 29 June

0700	Breakfast	Dining Hall #1, Bldg 543
0800-1100	26 NORAD Academies	Meet bus at O'Club (A Flight) Bldg 656 (B Flight)
0800-1500	Gunnery Range	Meet bus at O'Club (C Flight)
1100	Lunch	Dining Hall #1, Bldg 543
1300-1600	Flight Facilities Phoenix Approach Control	Bldg 473 (A Flight) Meet bus at O'Club (B Flight)
1730	Dinner	Dining Hall #1, Bldg 543

Friday, 30 June

0700	Breakfast	Dining Hall #1, Bldg 543
0800-1100	Academies 26 NORAD	Bldg 656 (A & B Flights) Meet bus at O'Club (C Flight)
1100	Lunch	Dining Hall #1, Bldg 543
1300	Wing Commander Formation	O'Club
1600	Fighter Pilots Beer Call	O'Club
1730	Dinner	Dining Hall #1, Bldg 543

20

Saturday, 1 July

0730	Breakfast	Dining Hall #1, Bldg 543
0830	Check Out and Baggage Loading	
1030	Lunch	Dining Hall #1, Bldg 543
1130	Bus to Aircraft	
1200	Depart Luke for Peterson Field	
1700	Arrive Peterson Field	
1730	Bus to USAFA	
1830	Dinner	MH

LUKE AFB

Barber Shop

Officer	935-3453
Bldg 684	
Mon-Fri	0800-1700
Sat	0800-1300

Bowling Center

Bldg S-157	Ext 2946
Mon, Tues, Thurs & Sat	0900-2300
Wed, Fri	1100-2300
Sun	1300-2200

Bus Service

Bus departs O'Club for the Greyhound bus station and Sky Harbor Airport.

Mon-Fri	0600, 0800, 1000, 1200, 1400, 1800- 2100
Sat, Sun	1300-2100

Laundry & Dry Cleaners

Bldg MTN50	935-5111
Mon-Fri	0715-1730
Sat	0800-1400

Post Office

Bldg 151	Ext 2516
Mon-Fri	0830-1700

Special Services Supply

Bldg 181	Ext 2653
Mon, Fri	0745-1630
Tues, Wed, Thurs	1200-1630
Sat, Sun	Closed

Swimming Pools	Ext 2446
Sun- Fri	1200-2000
Sat	1000-2000
Theater	
Bldg S-26	Ext 2255
Mon- Fri]	1900
Sat, Sun	1400, 1800, 2000
Chapel #1	
Bldg 799	Ext 2211
Mass	
Mon- Fri	1200
Sat	1730
Sun	0800, 1000, 1215
Protestant	
Sun	1100, 1900
Chapel #2	
Bldg 25	Ext 2597
Protestant	
Sun	0930
Episcopal	
Sun	0830
Dining Hall #1	
Bldg 543	Ext 2231
Breakfast	0430-0800
Lunch	1015-1300
Dinner	1630-1800

DRESS REQUIREMENTS FOR OFFICERS OPEN MESS:

Flight suits are permitted in the O'Club until 1800. After 1800 appropriate casual dress is permitted except when the Commander is having a function, then a coat and tie is required. Flight suits are permitted in the Stag Bar anytime it is open.

Published by
National Military Publications
9404 Magnolia Ave.
Riverside, California 92503
Telephone - (714) 687-6553

LUKE AIR FORCE BASE

Important Commercial Telephone Numbers:
Luke Air Force Base 935-7411
Gila Bend Auxiliary Field 683-2241
425th Tactical Fighter Training
Squadron (WAFB) 988-2611, Ext. 376

FOR ACTIVITY INFORMATION
DIAL "CALL"

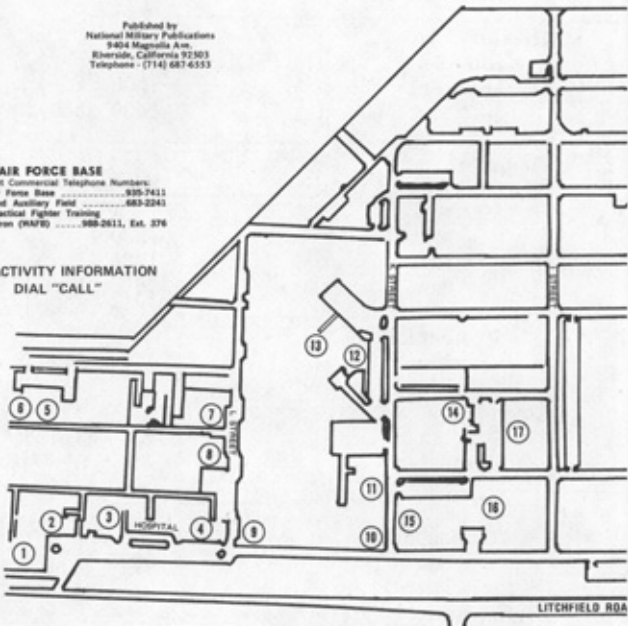

Map No.	Blgd No.	Phone No.	Street
14 Air Force Aid Society	1112	7241	3-18K
35 American Red Cross	17	2750	3-FAG
ARTS & CRAFTS HOBBY SHOPS			
47 Auto	248	2107	3-88D
47 Crafts	242	2722	0-38A
47 Photo	242	2502	0-38A
34 Bank—1st Nat'l of Ariz.	17	271-1264	3-FAG
40 Barber Shop—Main	114	935-3382	F-56E
52 NCO	257	935-3682	0-283
15 Officer	684	935-3453	K-182
33 Base Commander	12	2304	F-283
21 Base Exchange	28	935-3332	F-56E
32 Base Exchange Cafeteria	18	935-3132	3-FAG
42 Base Operations Cafeteria	439	935-4661	8-D&F
16 Base Housing Office	690	2640	2-18K
20 Beauty Shop	27	935-5850	F-56E
16 Base Biting Office	690	2229	2-18K
49 Bowling Lanes	157	2546	3-EAF
14 Central Base Personnel Office	659	2206	2-18K
9 Chapel #1	799	2087	4-FAG
23 Chapel #2	25	2211	L&I

Map No.	Blgd No.	Phone No.	Street
9 Chaplain's Offices	799	2211	L&I
61 Commissary	311	2563	A-5A7
29 Commissary Annex	1110	2733	Thunderbird Dr.
37 Communications Center	176	2443	F-1A2
37 Consolidated Mail Room	151	2727	F&J
32 Deputy Commander Logistics	11	2907	1-F&G
32 Deputy Commander Operations	11	2226	1-F&G
48 Educational Services	109	2278	3-D&E
30 Family Services	1112	7241	Thunderbird Dr.
41 Finance (Comptroller)	121	2906	6-D&F
30 Garden Shop	27	935-3212	G-6A7
31 Golf Driving Range	1111	2014	Thunderbird Dr.
43 Ground Safety Office	416	2652	D&B
38 Gymnasium	149	2241	F-38A
HOSPITAL			
7 Dental Clinic	842	2431	L-1&4
3 Emergency AF Clinic	886	2217	Hemp Complex
4 Flight Medicine	883	7341	L-1&4
8 Olt./OYN	863	2235	L-1&4
16 Housing Referral Office	690	7210	2-18K
24 Dining Hall #1	5A-3		G-3&4

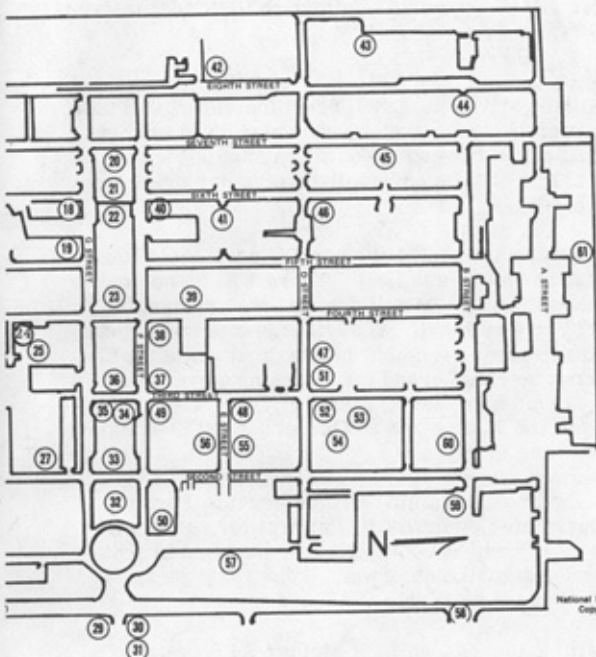

National Military Publications
Copyright © 1972

Map No.	Bldg No.	Phone No.	Street
25	590	2301	G-3&4
37	151	2405	F-3&4
After Duty Hours			
46	214	935-9345	6&D
6	855	2343	L-1&4
59	281	7224	2-8&D
56	163	2214	3&E
53	259	935-3682	3-8&D
2	867	2339	Hosp. Complex
33	12	2011	2-F&G
11	790	935-9311	K-1&2
20	27	935-4131	6-F&G
14	659	7241	3-1&A
39	129	2041	5&F
37	151	2516	F&J
SECURITY POLICE			
19	527	2200	G-6&7
18	518	2601	G-6&7
32	300	2000	K&J
57	195	2901	L-0&F

Map No.	Bldg No.	Phone No.	Street
SWIMMING POOLS			
13	2486	2486	K-3&4
54	268	935-3682	3-8&D
11	740	935-9311	K-1&2
22	26	2461	5-F&G
5	853	2525	3-L&N
60	324	2423	A-2&3
32	11	2101	1-F&G
VIP GUEST HOUSES			
10	785	2453	K-1&2
	786	2548	K-1&2
	11	2101	1-F&G
1	896	2225	Hosp. Complex
58	1150	2611	Litchfield Rd.
27	569	2625	G-2&4
44	404	2135	8&B
45	415	2947	7-8&D
45	931	2951	20-M
45	415	2156	7-8&D
55	164	2835	D-2&3

CADET INFORMATION

The cadet will pay particular attention to "Cadet Instructions,"

The VOQ fees are \$2 a night. Each individual will pay for his room through his element leader. The element leader will check out and make all payments for his element. This will be accomplished the day prior to departure.

Meals are scheduled for either an Officers Field Ration Mess or Airmans Dining Hall. There will be no cost to you for these meals. Meals during times designated OFF DUTY are optional. You will sign the meal list if you desire to eat government meals during this time. You will not be reimbursed for eating nongovernment meals. Permission can be granted by the Mission Commander for you to dine-out at Officers or NCO quarters for the evening meal.

Uniform for ground training will be service Foxtrot unless designated otherwise. Uniform for flying will be flight suit, combat boots, gloves, ~~asot~~ and flight cap unless designated otherwise. The flight jacket will also be worn on flights if needed.

Your mailing address while at Mather AFB is:

Cadet	759999K
Project "Air Cruise"	
VOQ Bldg #2750	
Mather AFB CA 95655	

Your mailing address while at Luke AFB is:

Cadet 759999K
Project "Air Cruise"
General Delivery
Luke AFB AZ 85301

Your mailing address while at Bergstrom AFB is:

Cadet 759999K
Project "Air Cruise"
General Delivery
Bergstrom AFB TX 78743

NOTE

All cadets who will be departing on leave from Luke AFB or Bergstrom AFB will take all personal items with them when they leave USAFA on 16 June. There will be no storage in the Air Cruise area of the New Dorm. Plan Ahead.

All cadets returning to the Academy from Air Cruise will vacate the Air Cruise area of the New Dorm NLT 1200, Sunday, 2 July 1972. All rooms will be cleaned, in proper order, with the floors waxed and buffed. Rooms will be inspected prior to vacating. All cadets going on leave from Luke AFB or Bergstrom AFB, will leave their room in the above described condition on 16 June 1972. Failure to comply with these instructions will result in a Form 10 for "failure to comply with specific instructions."

EMERGENCY PROCEDURES--T-29 AIRCRAFT

1. Crewmembers Responsibility. Each crewmember aboard a military aircraft must have a thorough knowledge of emergency procedures and equipment. He must be able to cope effectively with that sudden and unusual situation which constitutes an emergency. He must know his job, react accordingly, and avoid jeopardizing the survival efforts of his fellow crewmembers.

2. Emergency Exits. You must know the location of the emergency exits and how to use them should the occasion arise.

a. Bailout

(1) The primary exit is the rear service door.

(2) The secondary exit is the bailout door over the right wing.

b. Ground Emergency

(1) Main entrance door--this will be closed once the #2 engine is started.

(2) Rear service door.

(3) Two escape hatches in the right cabin wall; one, in the left cabin wall.

(4) Bailout door over the right wing.

(5) Astrodomes (the number will vary with the aircraft).

3. Exit Use.

a. Rear Service Door - Jettisoned by turning its handle to the OPEN position and pulling up on the

jettison handle located just forward of the door. Since the rear service door is about eight feet from the ground, an emergency escape rope is provided and when used is installed in the center bayonet receptacles in the fore and aft side of the rear service door frame. The rope may be stowed in the overhead rack in the rear of the aircraft or adjacent to the rear service door.

b. Escape Hatches - Released inward by pulling down on the handle in the upper portion of the hatch.

c. Bailout Door - Jettisoned by pulling up on the release handle located just aft of the door and then pushing the door out.

d. Astrodomes - Released inward by pulling down on the "T" handles, removing the rubber seal around the base of the dome, and then pulling the dome in by the handle. There is a grounding strap which must be cut with a crash axe.

4. Signals and Responses.

a. Ground Emergency - ONE long sustained ring of the emergency bell and/or verbal commands--abandon aircraft (the instructor will direct your exit if at all possible).

b. Crash Landing - SIX short rings and/or verbal commands--prepare to crash land.

(1) Secure loose equipment.

(2) Flight jacket and gloves ON.

(3) Interphone--Monitor.

(4) Crash Landing Position:

(a) Seat belt--Fastened.

(b) Brief case, parachute, available padding--placed between desk edge and chest to absorb impact.

ONE LONG RING--BRACE FOR IMPACT
AFTER IMPACT:

(1) Remain seated until aircraft has come to a complete stop.

(2) Check for and assist injured personnel.

(3) Carry first aid kits (there are five first aid kits located on the right side cabin wall).

(4) Exit aircraft and assemble upwind of the aircraft.

c. Inflight Fire

(1) Notify crew--use CALL position and describe location and intensity.

(2) Prepare for crash landing--if parachutes are on board, prepare for bailout.

(3) Interphone--Monitor.

(4) All student electrical equipment--OFF.

(5) Fire fighting--as directed by instructor.

d. BAILOUT - THREE SHORT RINGS and/or verbal command. PREPARE TO BAILOUT.

(1) Don flight jacket and gloves.

- (2) Don and adjust harness.
- (3) Snap on parachute pack.
- (4) Clear aisles.
- (5) Take seat, fasten seat belt, monitor normal interphone.
- (6) First aid kits--secure to person.
- (7) Rear service door--jettisoned by instructor.

ONE LONG RING -- BAILOUT

ORDER OF BAILOUT

- (1) Rear to front.
- (2) Jumpmaster.
- (3) Pilot.

5. Parachute Inspection.

- a. Check pack cover for condition.
- b. Check Log (Form 46) for 30-day inspection and 120-day repack.
- c. Check for exposed canopy.
- d. Check tension of packing bands.
- e. Open flap and check for:
 - (1) Bent rip cord pins.
 - (2) Frayed rip cord cable.

(3) Defective grommets.

6. Parachute Harness Fittings.

- a. Open leg and chest snaps.
- b. Set proper index number.
- c. Place sling under buttocks.
- d. Tighten leg straps.
- e. Tighten chest straps.
- f. Adjust horizontal backstrap.
- g. Stow excess webbing.